



US Army Corps
of Engineers
Seattle District

Public Notice of Application for Permit

US Army Corps of Engineers

Regulatory Branch
Post Office Box 3755
Seattle, WA 98124-3755
Telephone: (805) 585-2149
ATTN: Emma Ross
Project Manager

Public Notice Date: March 2, 2021

Expiration Date: April 1, 2021

Reference No.: NWS-2008-00513-AQ

Name: Taylor Shellfish – Little

Skookum Okada

Interested parties are hereby notified that an application has been received for a Department of the Army permit in accordance with Section 10 of the Rivers and Harbors Act of 1899, for certain work described below and shown on the enclosed drawings dated January 28, 2021.

The Corps will review the work in accordance with Section 404 of the Clean Water Act (CWA) and Section 10 of the Rivers and Harbors Act. Ecology will review the work pursuant to Section 401 of the CWA, with applicable provisions of State water pollution control laws and the Coastal Zone Management Act.

The Corps will also review the work in accordance with Section 14 of the Rivers and Harbors Act of 1899, as codified at 33 U.S.C. Section 408 (Section 408), for work that may alter a Corps civil works project. An alteration is defined as any action that builds upon, alters, improves, moves, occupies, or otherwise affects the usefulness, or the structural or ecological integrity of a Corps federally authorized project.

APPLICANT: Taylor Shellfish Farms
130 SE Lynch Road
Shelton, WA 98484
Telephone: (360) 426-6178

AGENT: Taylor Shellfish Farms
Attention: Erin Ewald
130 SE Lynch Road
Shelton, WA 98484
Telephone: (360) 426-6178
Email: erine@taylorshellfish.com

LOCATION: The proposed project is located within Little Skookum Inlet, in Shelton, Mason County, WA (lat.: 47.143159, long.: -123.064984). Section 9, Township 19 North, Range 3 West.

WORK: This proposed project is to commercially cultivate up to 23.45 acres of clams, and oysters between +4.5 foot (ft.) and -4.5 ft. Mean Lower Low Water (MLLW) tidal elevations on parcels 319093080790, 319093480490, 319094280800 and 319093070270 in Little Skookum Inlet. The cultivation of oysters for commercial production are grown in bags, near bottom, and on- bottom as both singles and clusters. Harvest takes place manually by hand

during low tide and oysters are placed into tubs for pick up and transfer. Bags are harvested by pulling and emptying oysters onto barges for transfer. Bags are reused and hatchery seed is used.

Manila clam seed is broadcast by hand into the intertidal area. Some areas are netted, and some are not. Harvest takes place manually by hand at low tide by using rakes to loosen the sediment and clams are collected. The grower may also use a mechanical clam digger, which is powered by a small engine that propels a blade to loosen the soil and collect clams. The clams are collected by a rake under the machine that gathers them onto a conveyor belt and placed in a tub. Once the clams are harvest they are placed into sacks for pick up by boat. Littleneck and butter clams may be harvested incidentally when seeded clams are harvested.

PURPOSE: The purpose of the proposed project is to provide shellfish for human consumption.

ADDITIONAL INFORMATION: The applicant is requesting a 5-year permit. Copies of this public notice which have been mailed or otherwise physically distributed feature project drawings in black and white. The electronic version features those drawings in color, which we think more accurately communicates the scope of project impacts. To access the electronic version of this public notice, go to the Seattle District's web page at <http://www.nws.usace.army.mil/> and under the heading Open Public Comment Periods select Regulatory Public Notices. Recently-issued public notices are listed in chronological order of the date of issuance. Select and view the listing for this project.

The location of the line of mean high water/high tide line shown on the project drawings have not yet been verified by the U.S. Army Corps of Engineers (Corps). If the Corps determines the boundaries of the wetland/waters are substantially inaccurate a new public notice may be published.

MITIGATION: No mitigation is proposed at this time.

ENDANGERED SPECIES: The Endangered Species Act (ESA) requires federal agencies to consult with the National Marine Fisheries Service (NMFS) and/or U.S. Fish and Wildlife Service (USFWS) pursuant to Section 7 of the ESA on all actions that may affect a species listed (or proposed for listing) under the ESA as threatened or endangered or any designated critical habitat. After receipt of comments from this public notice, the U.S. Army Corps of Engineers will evaluate the potential impacts to proposed and/or listed species and their designated critical habitat.

ESSENTIAL FISH HABITAT: The Magnuson-Stevens Fishery Conservation and Management Act, as amended by the Sustainable Fisheries Act of 1996, requires all Federal agencies to consult with the NMFS on all actions, or proposed actions, permitted, funded, or undertaken by the agency, that may adversely affect Essential Fish Habitat (EFH). The proposed action would impact EFH in the project area. If the U.S. Army Corps of Engineers (Corps) determines that the proposed action may adversely affect EFH for federally managed fisheries in Washington waters, the Corps will initiate EFH consultation with the NMFS. The Corps' final determination relative to project impacts and the need for mitigation measures is subject to review by and coordination with the NMFS.

CULTURAL RESOURCES: The work has previously been permitted by the Corps and reviewed for Section 106. A search of the Washington Information System for Architectural and Archaeological Records Data online database showed no previously recorded historic properties in the permit area. The nature, scope, and magnitude of the work to be permitted is such that there is little likelihood that a historic property exists or may be affected, given: 1) it involves permitting of an existing shellfish operation; 2) harvesting is taking place in areas that have already been commercially harvested for the same species of shellfish in the past; and 3) no new ground disturbance is authorized. We are requesting your comments and would like to know if you have any knowledge or

concerns regarding historic properties, including sites of religious and cultural significance that would be potentially affected by the permitted activity.

After receipt of comments from this public notice, the Corps will evaluate potential impacts and consult with the State Historic Preservation Officer and Native American Tribes in accordance with Section 106 of the National Historic Preservation Act, as appropriate.

PUBLIC HEARING: Any person may request, in writing, within the comment period specified in this notice, that a public hearing be held to consider this application. Requests for public hearings shall state, with particularity, the reasons for holding a public hearing.

EVALUATION: The decision whether to issue a permit will be based on an evaluation of the probable impacts, including cumulative impacts, of the proposed activity on the public interest. That decision will reflect the national concern for both protection and utilization of important resources. The benefits, which reasonably may be expected to accrue from the proposal, must be balanced against its reasonably foreseeable detriments. All factors which may be relevant to the proposal will be considered, including the cumulative effects thereof; among those are conservation, economics, aesthetics, general environmental concerns, wetlands, historic properties, fish and wildlife values, flood hazards, floodplain values, land use, navigation, shoreline erosion and accretion, recreation, water supply and conservation, water quality, energy needs, safety, food and fiber production, mineral needs, considerations of property ownership, and, in general, the needs and welfare of the people.

The U.S. Army Corps of Engineers is soliciting comments from the public; Native American Nations or tribal governments; Federal, State, and local agencies and officials; and other interested parties in order to consider and evaluate the impacts of this activity. Any comments received will be considered by the Corps to determine whether to issue, modify, condition, or deny a permit for the work. To make this decision, comments are used to assess impacts on endangered species, historic properties, water quality, general environmental effects, and the other public interest factors listed above. Comments are used in the preparation of an Environmental Assessment and/or an Environmental Impact Statement pursuant to the National Environmental Policy Act. Comments are also used to determine the need for a public hearing and to determine the overall public interest of the activity.

COMMENT AND REVIEW PERIOD: Conventional mail or e-mail comments on this public notice will be accepted and made part of the record and will be considered in determining whether authorizing the work would not be contrary to the public interest. In order to be accepted, e-mail comments must originate from the author's e-mail account and must include on the subject line of the e-mail message the permit applicant's name and reference number as shown below. All e-mail comments should be sent to emma.b.ross@usace.army.mil. Conventional mail comments should be sent U.S. Army Corps of Engineers, Regulatory Branch, Post Office Box 3755, Seattle, Washington, 98124-3755. Either conventional mail or e-mail comments must include the permit applicant's name and reference number, as shown below, and the commenter's name, address, and phone number. All comments received will become part of the administrative record and are subject to public release under the Freedom of Information Act including any personally identifiable information such as names, phone numbers, and addresses. All comments whether conventional mail or e-mail must reach this office, no later than the expiration date of this public notice to ensure consideration. Please include the following name and reference number:

Taylor Shellfish Company, NWS-2008-00513-AQ

Encl: Figures (3 pages)

Taylor Shellfish - Okada

Total parcel: Approximately 23 acres
Total project area: 23 acres

Culture from tidal elevation +4.5 to -4.5

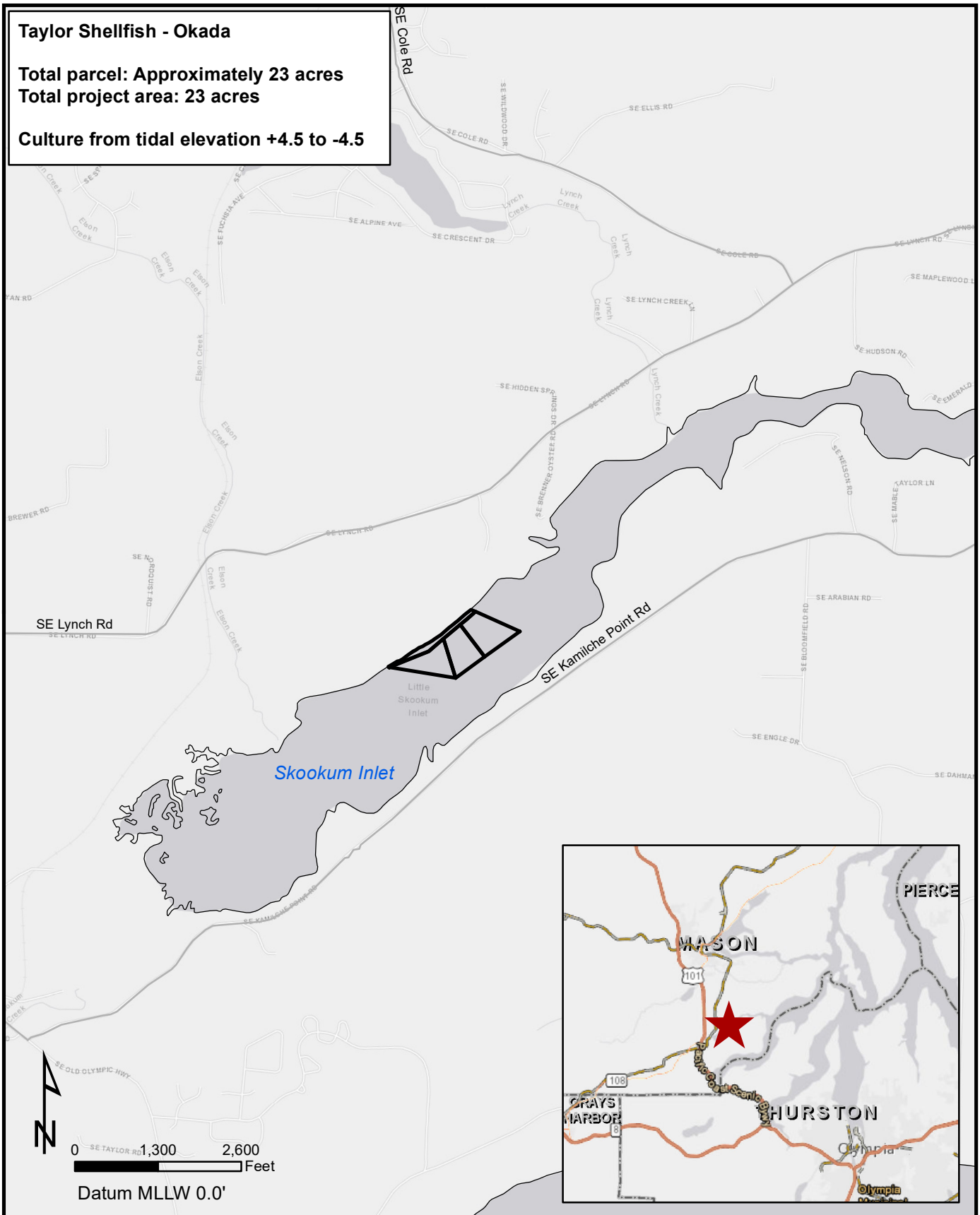

Document Path: M:\Working\Erin_Working\Map_Projects\LittleSkookum\Okada_Extent_V2.mxd

REFERENCE: NWS 2008-513

APPLICANT: Taylor Shellfish

ADJACENT PROPERTY OWNERS:

Please refer to
Table of Property Owners

Location: T19N, R03W, S16

Lat/Long: 47.143108 / -123.064964

PAGE 1 of 3 Date: 5/6/2020

PROJECT: Taylor Ownership,

Little Skookum - Okada

IN: Skookum Bay

Near/At: City of Shelton

County: Mason

State: WA

Little Skookum Okada Farm

Project area: 23 Total Acres

**Netted / Gear
Near / On Bottom Culture
23 acres Clam and Oyster cultivation from
tidal elevation +4.5' to -4.5'**

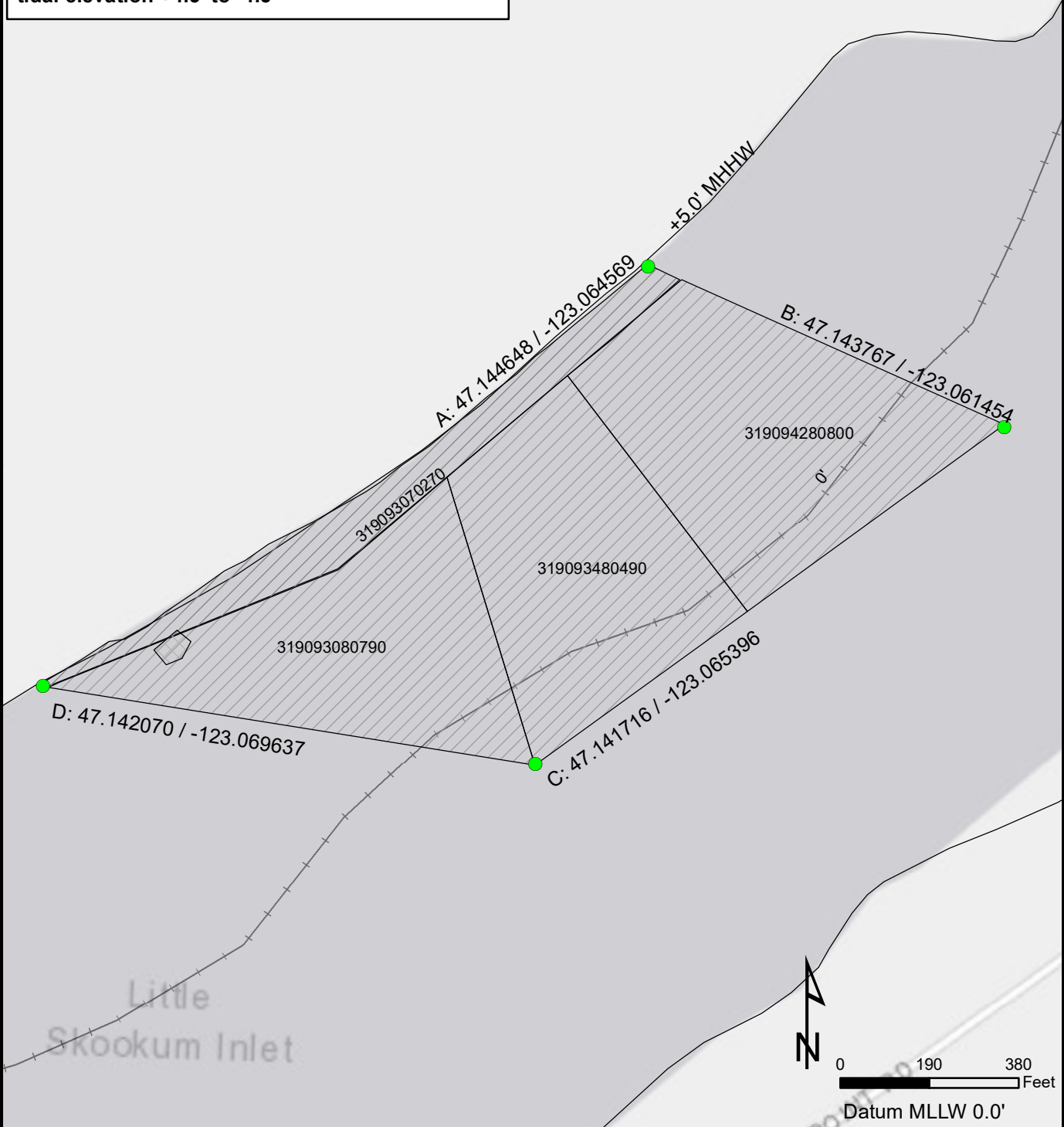

Document Path: M:\Working\Erin_Working\Map_Projects\LittleSkookum\LittleSkookum_Okada_Details_V2.mxd

REFERENCE: NWS 2008-513

APPLICANT: Taylor Shellfish

ADJACENT PROPERTY OWNERS:
Please refer to
Table of Property Owners

Location: T19N, R03W, S16

Lat/Long: 47.143108 / -123.064964

PAGE 2 of 3 Date: 5/6/2020

**PROJECT: Taylor Ownership,
Little Skookum - Okada
IN: Skookum Bay
Near/At: City of Shelton
County: Mason
State: WA**

Typical Cross Section

Clam netted / non-netted

Oyster on bottom / bag on bottom

One or more of these typical culture methods may be used on site. Please refer to permit.

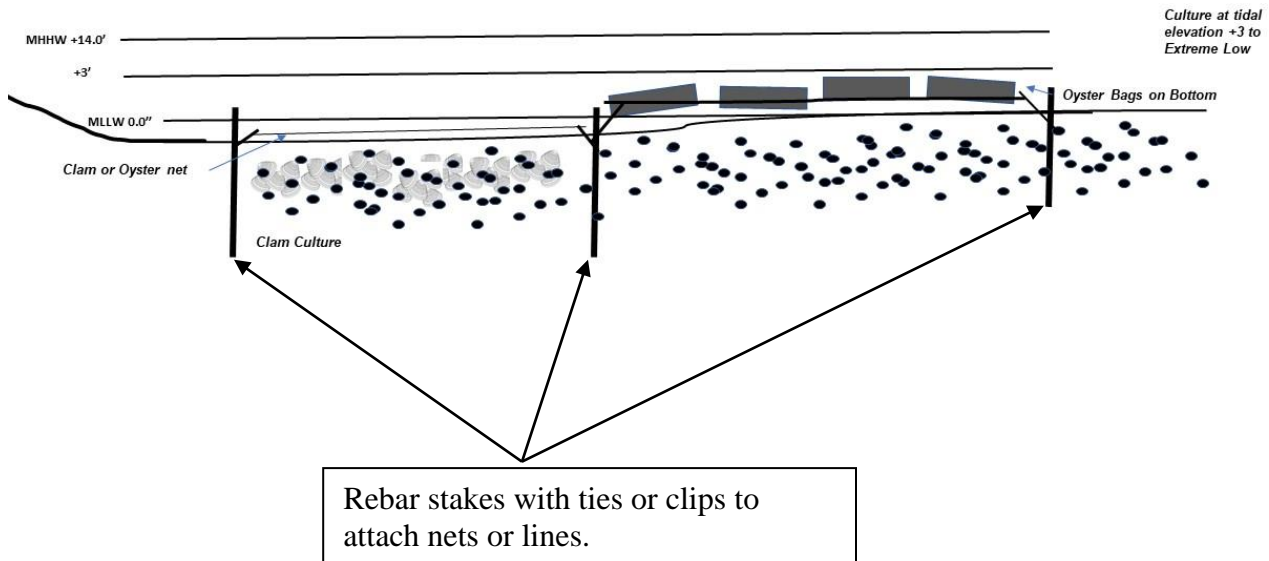

Reference: NWS 2008-00513
Applicant Name: Taylor Shellfish
Project: Little Skookum - Okada
Location: Little Skookum
Sheet 3 of 3 Date: 5/13/2020